



杭州国际博览中心
HANGZHOU INTERNATIONAL
EXPO CENTER

地址/Add.: 中国浙江省杭州市萧山区钱江世纪城奔竞大道353号
NO.353, Benjing Avenue, Qianjiang Century City, Xiaoshan District,
Hangzhou, Zhejiang, P.R. China
邮编/P.C.: 311215

电话/Tel: 86 (571) 8290 8888
传真/Fax: 86 (571) 8381 3580

会议及宴会销售热线/Convention & Banquet Hotline: 0571-83870667
展览销售热线/Exhibition Sales Hotline: 0571-82908163
酒店销售热线/Hotel Sales Hotline: 0571-82908165
网址/Web: www.hiechangzhou.com



HIEC



HANGZHOU INTERNATIONAL EXPO CENTER



杭州国际博览中心
HANGZHOU INTERNATIONAL EXPO CENTER

OVERVIEW

简介

杭州国际博览中心坐落于钱塘江南岸、钱江三桥以东——萧山区钱江世纪城，隶属于杭州奥体博览中心萧山建设投资有限公司，委托中国最大的会展输出管理集团——北辰会展集团管理运营。2016年9月4-5日，杭州国际博览中心作为G20杭州峰会主会场惊艳亮相，为“中国服务”写下了新的注脚。

杭州国际博览中心总建筑面积85万平方米，融合会议、展览、餐饮、旅游、酒店、商业、写字楼等多元业态，为会展场馆运营的创新模式带来了更多期待。得天独厚的地理位置、方便快捷的交通网络、规格多样的活动场地、江南意蕴与现代简约相融的场馆设计……从硬件设施到软件服务，从运营模式到营利模式，杭州国际博览中心开启中国第六代会展场馆的全新序幕！

To the east of Qiantang Third Bridge and on the south bank of Qiantang River stands Hangzhou International Expo Center (HIEC), the main venue of 2016 G20 Summit holding both modern facilities and the human spirits of classical Jiangnan.

With a convenient location and a space of 850,000 sqm, HIEC is a multi-functional complex consisting of convention, exhibition, hotel, catering, business and offices, bringing in a brand-new pattern. By virtue of the easy access, a variety of event venues and modern design with traditional Jiangnan implication, HIEC starts the sixth generation of event venue of China.



辉煌从这里开始

Brilliance Starts Here



850000m²

建筑面积

Construction Area

90000m²

展览面积

Exhibition Area

65000m²

空中花园

Sky Garden

10000m²

无柱多功能厅

Column-free

Multi-function Hall



3000m² 4F 大会议厅 Main Conference Hall



1800m² 2F 新闻发布厅 Press Conference Room



1300m² 1F 多功能厅 Multi-function Hall

多变的会议场地
Multi-Function Conference Area

会议

CONFERENCE

61个会场，可满足大、中、小型各类会议使用需求。最大10000平方米无柱多功能厅，配备16路同声传译与顶级会议视听设备，打造绝佳会议体验。

61 meeting rooms could meet various demands. The largest column-free multi-function hall with 10,000 sqm is equipped with 16 tracks of simultaneous interpretation and high-standard multimedia digital devices, creating top conference experience.

2

单厅面积 10000m²

4D无柱多功能厅

Column-Free Multi-function Hall, 10,000m²

3

展览 EXHIBITION

展览面积9万平方米，可容纳国际标准展位4500个，满足特种展览、大型集会、体育休闲等不同规模及不同类型的展会需求。地下停车场共可提供4000个车位。

Exhibition area of 90,000 sqm covers 4,500 standard booths of international standard will meet the needs for various scales and types of exhibitions, with 4,000 parking spaces provided in the basement parking.



9600m² 1D 展厅 Exhibition Hall



灵活的
展览空间
Flexible
Exhibition
Area

4

酒店 HOTEL

杭州国际博览中心北辰大酒店共19层，客房总数262间，配备落地景观窗，可俯瞰壮丽的钱塘江景和雅致的空中花园，一线江景尽收眼底。房间设计风格源自于钱塘江的一线潮，将杭州“山美、水美、境幽史悠”的内涵融入其中，以此整合各空间功能，做到形式与功能的完美统一。

高级定制的床上用品、充足的室内空间，让您尽情享受奢华商务品味。床具的柔和响应、完美承托，可让您充分放松休憩、一夜好眠，以充沛的精力迎接美好的明天。

North Star Hangzhou International Expo Center Hotel has 19 floors with 262 guest rooms in total, offering panoramic views of Qiantang River from French windows and the Sky Garden. Inspired by the one-line tidal bore of Qiantang River, our interior design embraces the art, the luxury and the splendour of a contemporary hotel, with an eye towards city context both of rich culture and picturesque landscape. We provide luxury indoor space and facilities to guarantee the comfort of guests' stay. Made-to-order bedding sets, ergonomic mattresses, all to create a favourable environment for better sleeping quality.

简约精致 典雅舒适
Design of Elegance and Comfort



杭州国际博览中心北辰大酒店是按照五星标准建造的豪华型商务酒店，坐落于钱塘江南岸、钱江三桥以东，矗立于萧山区钱江世纪城核心区，俯瞰钱塘江之壮观美景，一览钱江世纪城之新风。酒店设有西餐厅、中餐厅和大堂吧，我们诚邀您共赴令人难忘的美食之旅。餐厅氛围优雅且各具特色，为您提供丰盛可口的各式餐饮，并提供贴心周到的全天候送餐服务。另有配套无柱式多功能会议厅和VIP接待室，是您举办各种高端商务会议以及私人宴会的理想场地。以高标准配套的数字多媒体设备，让您在举办各种商务活动和社交聚会时都显得游刃有余。

On the south bank of Qiantang River and to the east of Qiantang Third Bridge, North Star Hangzhou International Expo Center Hotel is a luxury hotel with five-star facilities. We offer spectacular views of Qiantang River and fresh style of the Qianjiang Century City.

A Chinese Restaurant, a western restaurant and a lobby bar await you here. With elegant and characteristic design, the restaurant is ready to provide a range of food and hearty delivery service.

As to commercial service, our column-free multifunctional hall and VIP reception rooms are ideal choices for top-level events. High-standard multimedia digital devices are also available in assist with business and social activities.



5

空中花园

SKY GARDEN



空中花园，是目前亚洲面积最大、功能最全、中国特色最浓、生态环境最优的屋顶花园，亦是举行G20杭州峰会领导人餐前酒会的地点。

65000m²的空中园林蜿蜒曲折，极具江南特色，花园整体以“西湖明珠从天降，龙飞凤舞到钱塘”为设计理念，吸收了中国古典园林中多种元素，诗意地阐释了江南园林的独特艺术气息。

Sky Garden, the very venue for leaders' cocktail party during the G20 Hangzhou Summit, ranks as the largest and the most environment friendly roof garden in Asia with an oriental style. The garden with an area of 65,000 sqm represents the origin of traditional philosophy based on close ties with the nature. With the idea that "West Lake, a pearl dropping from the Heaven, attracts great figures to Qiantang", it is a poetical interpretation of Chinese classical landscaping.

1F 会议区

Conference Area

会议区平面图
conference Area Floor Plan

- 会议室
Conference Rooms
- VIP室
VIP Room
- 序厅
Lobby
- 入口
Entrance
- 自动扶梯
Escalator
- 电梯厅
Elevator
- 卫生间
Restroom

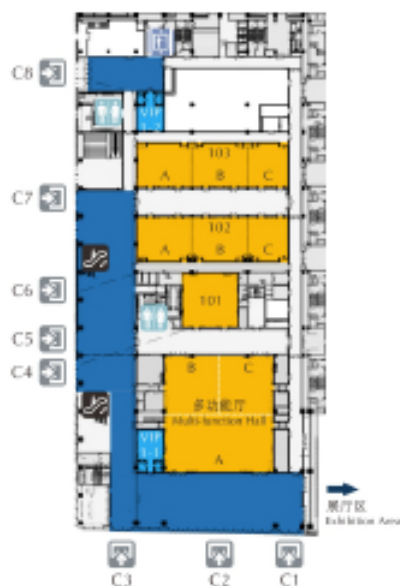

会议室 Conference Rooms	长×宽×高 [m] L×W×H	面积 [m²] Area	建议容纳人数 Recommended Number of Attendees				
			剧院式 Theatre	课桌式 Classroom	回字型 Hollow Square	宴会 Banquet	酒会 Reception
多功能厅 Multi-function Hall	36x36x5	1300	800	500	/	500	1000
多功能厅 A Multi-function Hall	18x36x5	650	400	350	/	250	540
多功能厅 B,C Multi-function Hall	18x18x5	325	200	150	/	100	270
101	18x17x4.7	300	200	150	80	100	250
102	48x14x5	650	400	350	130	200	540
102A	18x14x5	250	150	130	45	70	200
102B	18x14x5	250	150	130	45	70	200
102C	14x12x5	160	100	90	40	50	130
103	48x14x5	650	400	350	130	200	540
103A	18x14x5	250	150	130	45	70	200
103B	18x14x5	250	150	130	45	70	200
103C	14x12x5	160	100	90	40	50	130
VIP1-1	10x8.6x5	80	/	/	/	/	/
VIP1-2	8.6x8.6x5	70	/	/	/	/	/

2F 会议区

Conference Area

会议区平面图
conference Area Floor Plan

- 会议室
Conference Rooms
- VIP室
VIP Room
- 序厅
Lobby
- 入口
Entrance
- 自动扶梯
Escalator
- 电梯厅
Elevator
- 卫生间
Restroom
- 美食连廊
Gourmet Corner
- 问询处
Information Center

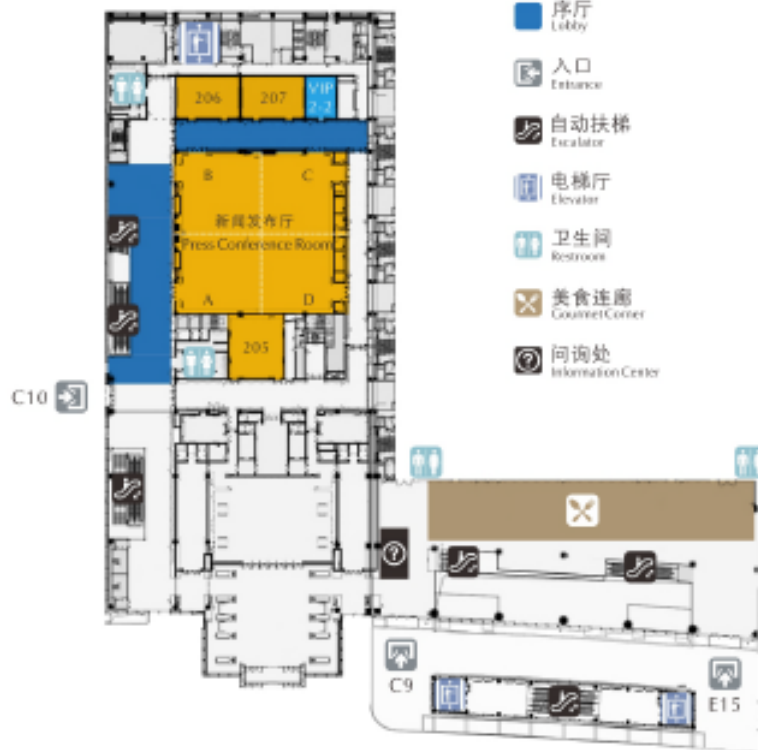

会议室 Conference Rooms	长×宽×高 [m] L×W×H	面积 [m²] Area	建议容纳人数 Recommended Number of Attendees				
			剧院式 Theatre	课桌式 Classroom	回字型 Hollow Square	宴会 Banquet	酒会 Reception
新闻发布厅 Press Conference Room	43x42x11	1800	1200	800	/	800	1500
新闻发布厅 A,B Press Conference Room C,D	21x21x11	450	300	200	/	200	370
205	16x14x4	230	/	/	/	/	/
206	16x11x5.4	170	120	/	/	/	/
207	16x11x5.4	170	120	/	/	/	/
VIP2-2	11x8x4.7	80	/	/	/	/	/

3F 会议区

Conference Area

会议区平面图
conference Area Floor Plan

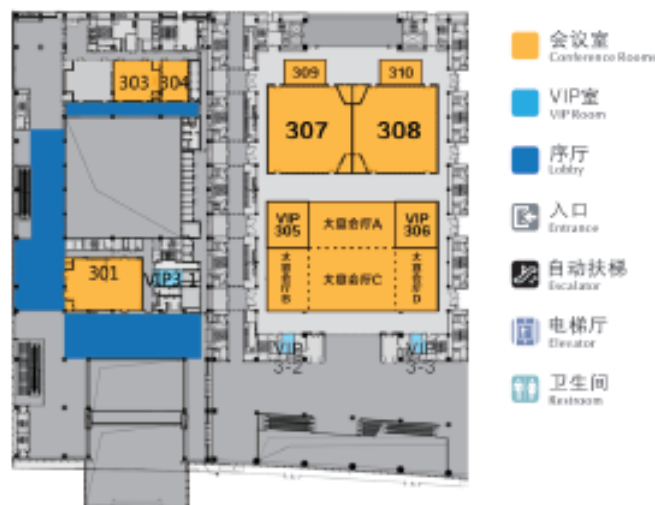

会议室 Conference Rooms	长x宽x高 (m) LxWxH	面积 (m ²) Area	建议容纳人数 Recommended Number of Attendees				
			剧院式 Theatre	课桌式 Classroom	回字型 Hollow Square	宴会 Banquet	酒会 Reception
301	29x19x5.5	520	380	280	/	160	430
303	18x16x5.5	280	180	130	/	100	200
304	15x10x3.9	150	/	/	/	/	/
VIP3-1	10x5x3.4	50	/	/	/	/	/
VIP3-2	6*7*4.6	40	/	/	/	/	/
VIP3-3	6*7*4.6	40	/	/	/	/	/
大宴会厅 Grand Ballroom		2130	1650	825	/	840	1200
大宴会厅 A Grand Ballroom A	36*13*8	470	450	170	/	160	320
大宴会厅 B Grand Ballroom B	14*26*8	360	250	120	/	120	220
大宴会厅 C Grand Ballroom C	36*26*8	940	750	470	/	300	550
大宴会厅 D Grand Ballroom D	14*26*8	360	250	120	/	120	220
VIP305	11*10*4.6	110	/	/	/	/	/
VIP306	11*10*4.6	110	/	/	/	/	/
307	32*31*8	1000	530	350	/	300	600
308	32*31*8	1000	530	350	/	300	600
309	16*9*5.5	140	/	/	/	/	/
310	16*9*5.5	140	/	/	/	/	/

4F 会议区

Conference Area

会议区平面图
conference Area Floor Plan



会议室 Conference Rooms	长x宽x高 (m) LxWxH	面积 (m ²) Area	建议容纳人数 Recommended Number of Attendees				
			剧院式 Theatre	课桌式 Classroom	回字型 Hollow Square	宴会 Banquet	酒会 Reception
大会议厅 Main Conference Hall	65x47x10.2	3000	2000	1300	/	1200	2200
大会议厅 A Main Conference Hall A	30x47x10.2	1350	900	600	/	550	1000
大会议厅 B Main Conference Hall B	35x47x10.2	1650	1100	700	/	650	1200
401	18x10x5.5	180	120	80	40	50	150
402	18x10x5.5	180	120	80	40	50	150
403	18x10x5.5	180	120	80	40	50	150
404	18x10x5.5	180	120	80	40	50	150
VIP4-1~4-4	5x2.6x3	10	/	/	/	/	/
VIP4-5~4-6	7x6x4.7	40	/	/	/	/	/
VIP4-7	15x10x4.4	150	/	/	/	/	/

1F 展览区

Exhibition Area

展览区平面图
Exhibition Floor Plan Area

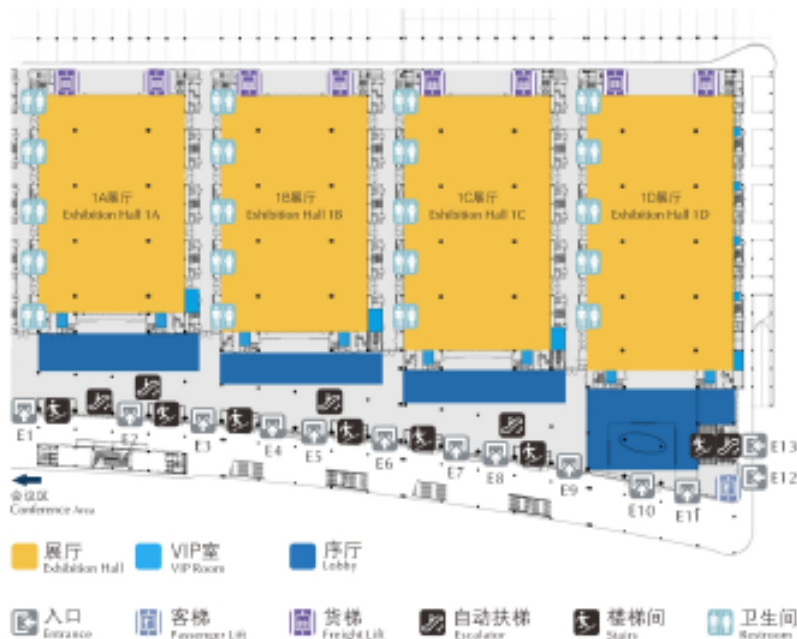

展厅参数 Exhibition Hall	1A	1B	1C	1D
长×宽(m) L×W(m)	107×72	116×72	125×72	134×72
展厅面积(m ²) Exhibition area (m ²)	7700	8300	9000	9600
净高(m) Clear Height (m)	12			
地面承重(Um ²) Floor Load (Um ²)	5			
序厅长×宽(m) Lobby L×W(m)	84×16	81×15	84×16	58×39
序厅面积(m ²) Lobby Area (m ²)	1512	1215	1344	2262
后货卷帘门尺寸长×高(m) Size of back Roll-Up Door for Freight L×H (m)	26×3.9			
后货卷帘门两侧货门宽×高(m) Size of Freight Doors on Both Sides of the Back Roll-Up Door H×W (m)	1.9×2.2			
后货门两侧客梯通道门宽×高(m) Quantity of Passenger Lift H×W (m)	1.3×2.2			
货梯数量 Quantity of Freight Lift	3T×1 / 5T×2			
货梯长×宽×高(m) Size of Freight Lift L×W×H(m)	5.9×2.5×2.3 / 3.4×2.4×2.3			
每条沟地沟盖板规格(m)×数量(个) Size(m) × Quantity of Trench Covers	{ 0.65×0.65 } × 110			
展厅水、电、气地沟数量(条)×间距(m) Trenches Quantity × Distance (m) Between the Trenches	11×8.4	12×8.4	13×8.4	14×8.4
供电方式 Power Supply Mode	地沟式 By Cable Trenching			
展厅电量(KW) Power (KW)	4760	5160	5560	5960

3F 展览区

Exhibition Area

展览区平面图
Exhibition Floor Plan Area

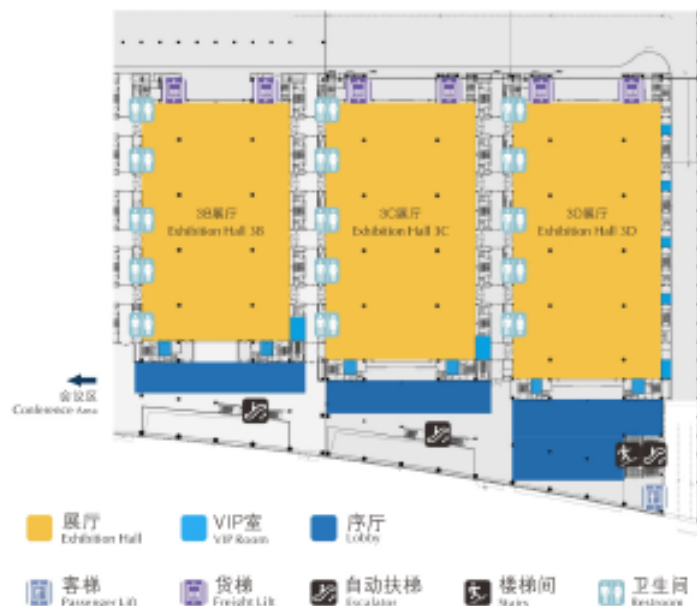

展厅参数 Exhibition Hall	3B	3C	3D
长×宽(m) L×W(m)	116×72	125×72	134×72
展厅面积(m ²) Exhibition area (m ²)	8300	9000	9600
净高(m) Clear Height (m)	10		
地面承重(Um ²) Floor Load (Um ²)	1.5		
序厅长×宽(m) Lobby L×W(m)	84×16	84×16	58×39
序厅面积(m ²) Lobby Area (m ²)	1344	1344	2262
后货卷帘门尺寸长×高(m) Size of back Roll-Up Door for Freight L×H (m)	26×3.9		
后货卷帘门两侧货门宽×高(m) Size of Freight Doors on Both Sides of the Back Roll-Up Door H×W (m)	1.9×2.2		
后货门两侧客梯通道门宽×高(m) Quantity of Passenger Lift H×W (m)	1.3×2.2		
货梯数量 Quantity of Freight Lift	3T×1 / 5T×2		
货梯长×宽×高(m) Size of Freight Lift L×W×H(m)	5.9×2.5×2.3 / 3.4×2.4×2.3		
每条沟地沟盖板规格(m)×数量(个) Size(m) × Quantity of Trench Covers	{ 0.65×0.65 } × 110		
展厅水、电、气地沟数量(条)×间距(m) Trenches Quantity × Distance (m) Between the Trenches	12×8.4	13×8.4	14×8.4
供电方式 Power Supply Mode	地沟式 By Cable Trenching		
展厅电量(KW) Power (KW)	2640	2840	3040

4F 展览区

Exhibition Area

展览区平面图
Exhibition Floor Plan Area

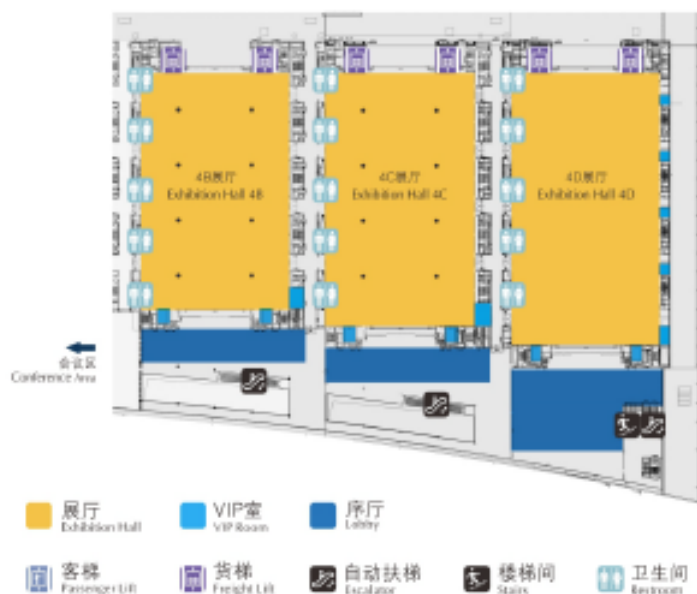

展厅参数 Exhibition Hall	4B	4C	4D
长 × 宽 (m) L × W (m)	116 × 72	125 × 72	134 × 72
展厅面积 (m ²) Exhibition area (m ²)	8300	9000	9600
净高 (m) Clear Height (m)	10		14
地面承重 (t/m ²) Floor Load (t/m ²)	1		
序厅长 × 宽 (m) Lobby L × W (m)	83 × 16	79 × 16	58 × 42
序厅面积 (m ²) Lobby Area (m ²)	1328	1264	2436
后货卷闸门尺寸长 × 高 (m) Size of back Roll-Up Door for Freight L × H (m)	26 × 3.9		
后货卷闸门两侧货门宽 × 高 (m) Size of Freight Doors on both Sides of the Back Roll-Up Door H × W (m)	1.9 × 2.2		
后货门两侧客梯通道门宽 × 高 (m) Quantity of Passenger Lift H × W (m)	1.3 × 2.2		
货梯数量 Quantity of Freight Lift	3T × 1 / 5T × 2		
货梯长 × 宽 × 高 (m) Size of Freight Lift L × W × H (m)	5.9 × 2.5 × 2.3 / 3.4 × 2.4 × 2.3		
每条沟地沟盖板规格 (m) × 数量 (个) Size (m) × Quantity of Trench Covers	(0.65 × 0.65) × 110		
展厅水、电、气地沟数量 (条) × 间距 (m) Trenches Quantity × Distance (m) Between the Trenches	12 × 8.4	13 × 8.4	14 × 8.4
供电方式 Power Supply Mode	地沟式 By Cable Trenching		
展厅电量 (KW) Power (KW)	2640	2840	2040

交通方式 Transportation

杭州国际博览中心地理位置优越，交通网络方便快捷。
With advantageous location, the Hangzhou International Expo Center boasts a fast and convenient traffic network.

驾车 Driving

距杭州萧山国际机场20分钟车程，途径机场高速、城市大道；
距杭州东站火车站20分钟车程，途径新塘路、市中心北路、奔竞大道；
距杭州城站火车站15分钟车程，途径秋石高架、城市大道、奔竞大道；
距杭甬高速萧山出口15分钟车程，途径鸿宁路、奔竞大道；

20 minutes' drive to Hangzhou Xiaoshan International Airport via Airport Expressway and Urban Highway;
20 minutes' drive to Hangzhou East Railway Station via Xintang Road, Shixin North Road and Benjing Avenue;
15 minutes' drive to Hangzhou Railway Station (Chengzhan) via Qiushi Viaduct, Urban Highway and Benjing Avenue;
15 minutes' drive to the Xiaoshan Exit of Hangzhou-Ningbo Expressway via Hongning Road and Benjing Avenue;

地铁 Metro

可乘坐地铁2号线，至“钱江世纪城”下站；
20-min walk to Qianjiang Century City metro station, Line 2;

公交 Bus

可乘坐公交419路，至“国际博览中心”下站。
1-min walk to International Expo Center bus stop (No.419).

